

4

3

2

1

REVISION DATA

REV	DESCRIPTION	DATE
A0	NEW DRAWING	2016-5-26

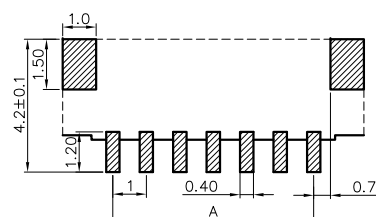
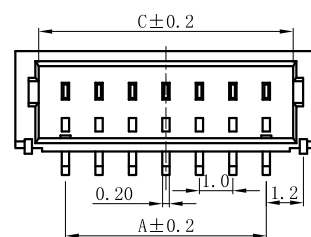
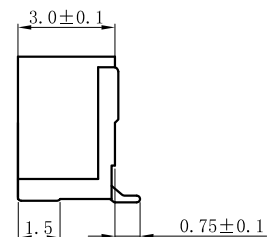
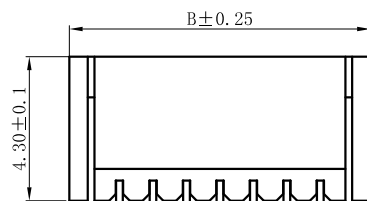
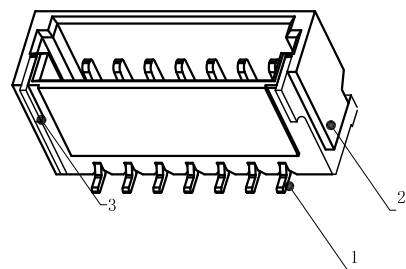
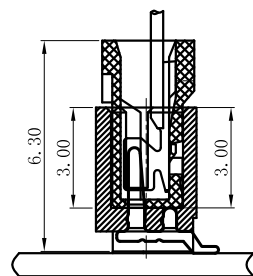
SH-AB
PCB寸法
PCB Layout

Current rating: 1.0A AC\DC (AWG #28)

Voltage rating: 50V AC\DC

Temperature range: -25°C to 85°C

Contact resistance: Initial value/20mΩ max

Insulation resistance: 100MΩ min

Withstanding voltage: 500V AC/ minute

Applicable wire: AWG #32 to #28

孔位 poles	A	B	C
2	1.0	4.0	2.6
3	2.0	5.0	3.6
4	3.0	6.0	4.6
5	4.0	7.0	5.6
6	5.0	8.0	6.6
7	6.0	9.0	7.6
8	7.0	10.0	8.6
9	8.0	11.0	9.6
10	9.0	12.0	10.6
11	10.0	13.0	11.6
12	11.0	14.0	12.6
13	12.0	15.0	13.6
14	13.0	16.0	14.6
15	14.0	17.0	15.6
16	15.0	18.0	16.6
17	16.0	19.0	17.6
18	17.0	20.0	18.6
19	18.0	21.0	19.6
20	19.0	22.0	20.6

序号	名称	材料
1	接触件	磷青铜 (镀锡)
2	基座	LCP (UL94-0)
3	焊片	磷青铜 (镀锡)

WF

G

R

11

XXX

XX

X

N

RXXX

Pitch
G PH1.00

R 90°

XX Positions

XXX Positions

G0 Gold Flash
SN Tin PlatedInsulator
Material
A PBT
B PA66
C PA6T
P PC
F PA9TW With peg
N NO Peg
L With lock
T Fixed tabs

RXXX

ANYCONN® 东莞市恩康电子有限公司

www.enkcom.com

DONGGUAN ANYCONN ELECTRONICS CO.,LTD

TOLERANCE	PROJECTON	TITLE:
ANGLE ±5°	DATE: 2016-5-26	SH-nAB
X.XXX ±0.10	DRAWN: ZHANG	PART NO: WFGR11XXXXXXXXNRXXX
X.XX ±0.20	CHECKED:	DRAWING NO:
X.X ±0.30	APPROVED:	REV: A0 UNIT: mm SCALE: 3:1 SIZE: A4
X. ±0.50		

4

3

2

1